

Exposed sink mixer ARCANA CERAMIC_AC000400

MODEL **AC000400**

Exposed sink mixer, swivel spout



AVAILABLE FINISHINGS

- | | | |
|---|-----------|-------------------------|
|  | 21 | 21 Chrome |
|  | 24 | 24 Gold |
|  | 26 | 26 Old Copper |
|  | 27 | 27 Old Bronze |
|  | 2A | 2A Satin Brushed Nickel |
|  | 74 | 74 Chrome/Gold |

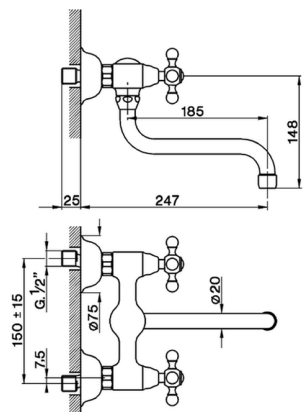

CHARACTERISTICS



Exposed sink mixer ARCANA CERAMIC_AC000400

cisal

AC 00040 (AC 00044)

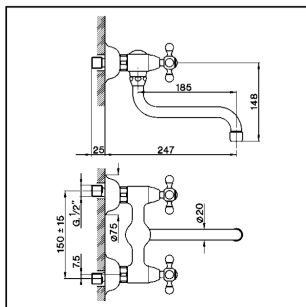

- Gruppo lavello
- *Sink mixer*
- Spültisch-Wandbatterie
- *Mélangeur évier mural*

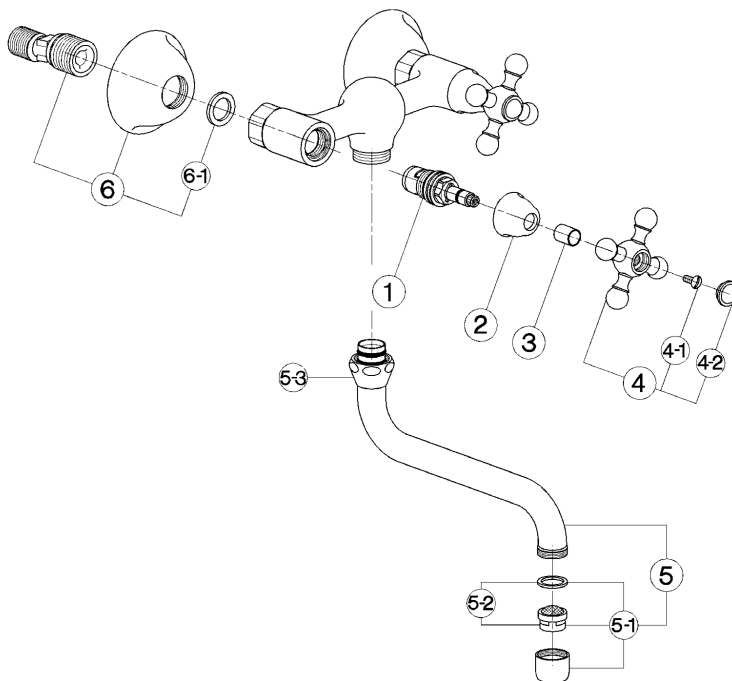

bar	PORTATA * FLOW RATE DURCHFLOSS DEBIT l/min.
0.5	10
1	14
2	19.5
3	24
4	27.5
5	31

* con resistenza silenziosa della classe di portata B (25.2 l/min. a 3 bar)
with hydraulic resistance of flow rate class B (25.2 l/min. at 3 bar)
mit geräuscharmen Widerstand der Durchflussklasse B (25.2 l/min. bei 3 bar)
avec aérateur classe B (25.2 l/min. à 3 bar)

NR.	DESCRIZIONE DESCRIPTION BESCHREIBUNG	N. CODICE CODE NO. WERKSNR. NR. CODE	NR.	DESCRIZIONE DESCRIPTION BESCHREIBUNG	N. CODICE CODE NO. WERKSNR. NR. CODE	NR.	DESCRIZIONE DESCRIPTION BESCHREIBUNG	N. CODICE CODE NO. WERKSNR. NR. CODE
1	Vitone ceramico DX per monoletti a gruppi "AC" <i>Ceramic headvalve 1/2" right "AC"-short</i> Keramikoberteil 1/2"-rechts-"AC"-kurz <i>Tête céramique 1/2" droite "AC"- courte</i>	ZZ 92858 0	5	Canna a S Ø20 interasse 185 <i>Swinging spout 185 Ø20</i> Auslauf-Rohr-S-185 Ø20 <i>Bec orientable 185 Ø20</i>	ZZ 90118 0			
2	Cappuccio coprivitone Ø32 H.21 "AC" <i>Escutcheon Ø32 H.21 "AC" headvalve</i> Abdeckkappe Ø32 H.21 "AC" <i>Rosace couvre-tête Ø32 H.21 "AC"</i>	ZZ92652 0	5-1	Aeratore M.22x1 IB <i>Mousseur M.22x1 IB</i> Perlator M.22x1 IB <i>Mousseur M.22x1 IB</i>	ZZ 92841 0			
3	Tubetto copriasta "AR" H.15,5 <i>Sliding cover tube "AR" H.15,5</i> Abdeckkappe Oberteil "AR" H.15,5 <i>Tube couvre-tête "AR" H.15,5</i>	ZZ 92619 0	5-2	Cartuccia per aeratore M. 22x1 <i>Mousseur cartridge M.22x1</i> Kart. 1/Perlator M.22x1 <i>Cartouche x mousseur M.22x1</i>	ZZ 92703 0			
4	Maniglia "AR" con vite e placchetta <i>Handle with screw and plate "AR"</i> Griff "AR" mit Schraube und Abdeckkappe <i>Croisillon avec vis et plaquette "AR"</i>	ZZ 90307 0	5-3	Calotta 3/4" es.29 Ø19,5 <i>Nut 3/4" Ø19,5</i> Mutter 3/4" Ø19,5 <i>Ecrou 3/4" Ø19,5</i>	ZZ 92615 0			
4-1	Vite M.4,5x10 tb. lt. zigrinata <i>Screw M.4,5x10</i> Schraube M.4,5x10 <i>Vis M.4,5x10</i>	ZZ 92609 0	6	Eccentrico con rosone "AC" <i>Eccentric connection with escutcheon "AC"</i> S - Anschluss m.Rosette "AC" <i>Excentrique + rosace "AC"</i>	ZZ 92826 0			
4-2	Placchetta a vite maniglia "AR" <i>Cap for handle "AR"</i> Abdeckkappe "AR" Griff <i>Plaquette cache - vis crois. "AR"</i>	ZZ 92617 0	6-1	Guarnizione NBR 90 SH. 24x16x2,7 <i>Gasket NBR 90 SH. 24x16x2,7</i> Dichtung NBR 90 SH. 24x16x2,7 <i>Joint NBR 90 SH. 24x16x2,7</i>	ZZ 92689 0			

AC.5

AC000400

<https://en.cisal.it/exposed-sink-mixer-arcana-ceramic-ac000400>

2025-12-05