

Exposed part for Single Lever One Box Valve HI-RISE_RI0BM010

MODEL
RI0BM010

Exposed part for Single Lever One Box Valve, 1 Outlet, Minimum depth of installation: 67 mm, without concealed part, for items ZA00B030-ZA00B031

AVAILABLE FINISHINGS

- | | | |
|-------------------------------------------------------------------------------------|-----------|------------------------------|
|  | 21 | 21 Chrome |
|  | 6X | 6X Matt White/Brushed Gold |
|  | 6V | 6V Matt White/Brushed Nickel |
|  | 5G | 5G Rose Gold |
|  | 4Q | 4Q Matt White |
|  | 40 | 40 Matt Black |
|  | 2W | 2W Brushed Gold |
|  | 2F | 2F Brushed Nickel |
|  | 24 | 24 Gold |
|  | 7W | 7W Matt Black/Brushed Gold |

CHARACTERISTICS

Cartridge Spare Parts **ZZ97179000**

35 mm Cartridge

Installation **Concealed**

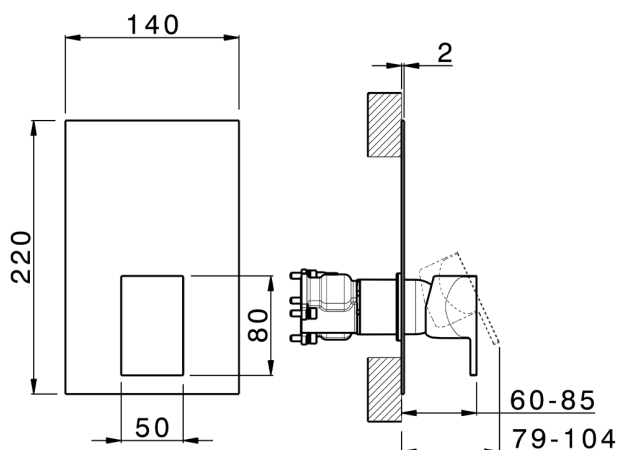

Required concealed parts **ZA00B031**

ZA00B030



One Box Universal Concealed Part ONE BOX_ZA00B031

MODEL **ZA00B031**

One Box Universal Concealed Part, for 1, 2 or 3 outlet thermostatic or single lever, without trim kit, with noise reducers, with sealing gasket

AVAILABLE FINISHINGS



04 04 Without finishing

CHARACTERISTICS

Concealed **1**



Thermostatic

The Cisal thermostatic is your personal water manager, helping you to handle, control and save water and energy.



One Box Universal Concealed Part ONE BOX_ZA00B030



MODEL **ZA00B030**

One Box Universal Concealed Part, for 1, 2 or 3 outlet thermostatic or single lever, without trim kit, without noise reducers, with sealing gasket

AVAILABLE FINISHINGS



04 04 Without finishing

CHARACTERISTICS

Concealed **1**



Thermostatic

The Cisal thermostatic is your personal water manager, helping you to handle, control and save water and energy.



2024-05-16