

## Exposed part for Single Lever One Box Valve HI-RISE\_RI0BM010

**MODEL**
**RI0BM010**

Exposed part for Single Lever One Box Valve, 1 Outlet, Minimum depth of installation: 67 mm, without concealed part, for items ZA00B030-ZA00B031

### AVAILABLE FINISHINGS

- |   |           |                              |
|---|-----------|------------------------------|
|    | <b>21</b> | 21 Chrome                    |
|    | <b>6X</b> | 6X Matt White/Brushed Gold   |
|    | <b>6V</b> | 6V Matt White/Brushed Nickel |
|   | <b>5G</b> | 5G Rose Gold                 |
|  | <b>4Q</b> | 4Q Matt White                |
|  | <b>40</b> | 40 Matt Black                |
|  | <b>2W</b> | 2W Brushed Gold              |
|  | <b>2F</b> | 2F Brushed Nickel            |
|  | <b>24</b> | 24 Gold                      |
|  | <b>7W</b> | 7W Matt Black/Brushed Gold   |

### CHARACTERISTICS

Cartridge Spare Parts **ZZ97179000**

**35 mm Cartridge**

Installation **Concealed**

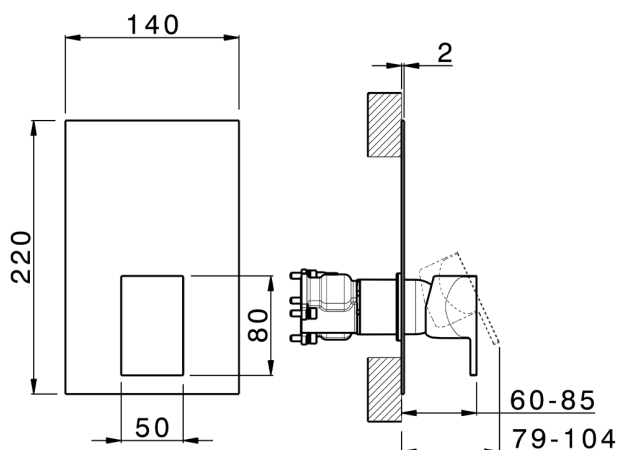

Required concealed parts **ZA00B031**

**ZA00B030**



## One Box Universal Concealed Part ONE BOX\_ZA00B031

MODEL **ZA00B031**

One Box Universal Concealed Part, for 1, 2 or 3 outlet thermostatic or single lever, without trim kit, with noise reducers, with sealing gasket

AVAILABLE FINISHINGS



**04** 04 Without finishing

CHARACTERISTICS

Concealed **1**

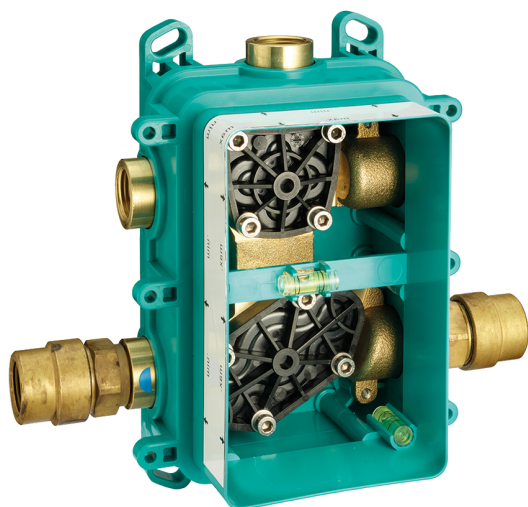

### Thermostatic

The Cisal thermostatic is your personal water manager, helping you to handle, control and save water and energy.



**One Box Universal Concealed Part ONE BOX\_ZA00B030**



MODEL                    **ZA00B030**

One Box Universal Concealed Part,for 1,2 or 3 outlet  
thermostatic or single lever,without trim kit,without  
noise reducers,with sealing gasket

## AVAILABLE FINISHINGS



## 04 04 Without finishing

## CHARACTERISTICS

Concealed	1
-----------	---

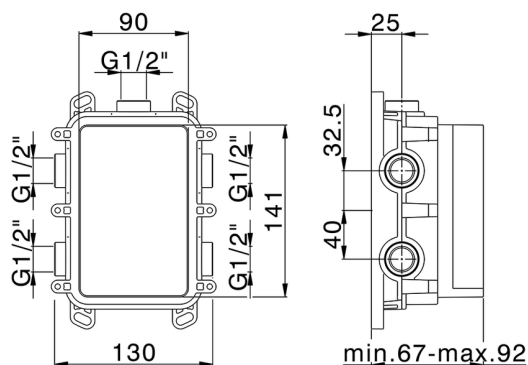

## Thermostatic

The CisaI thermostatic is your personal water manager, helping you to handle, control and save water and energy.



2024-04-29