

Exposed part for con.thermo.shower valve, 2-outlet X32_X1018100

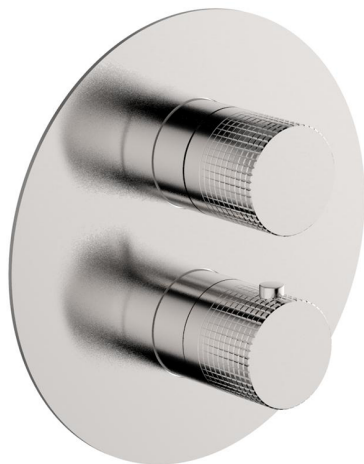

MODEL **X1018100**

Exposed part for con.thermo.shower valve,
2-outlet, with 2 outlet devistop, without concealed
part, for item ZA018101, Inox AISI 316L

AVAILABLE FINISHINGS



5H 5H Dark Brass Brushed



5L 5L Brushed Black Titanium



5N 5N Brushed Rose Gold



D1 D1 Brushed Inox

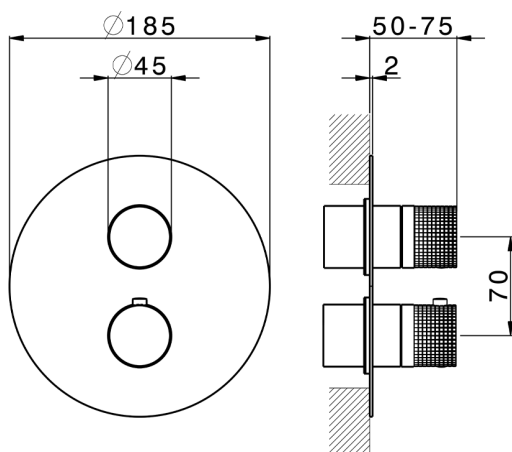

CHARACTERISTICS

Installation **Concealed**

Required concealed parts **ZA018101**



Thermostatic

The Cisal thermostatic is your
personal water manager, helping you
to handle, control and save water and
energy.



Exposed part for con.thermo.shower valve, 2-outlet X32_X1018100

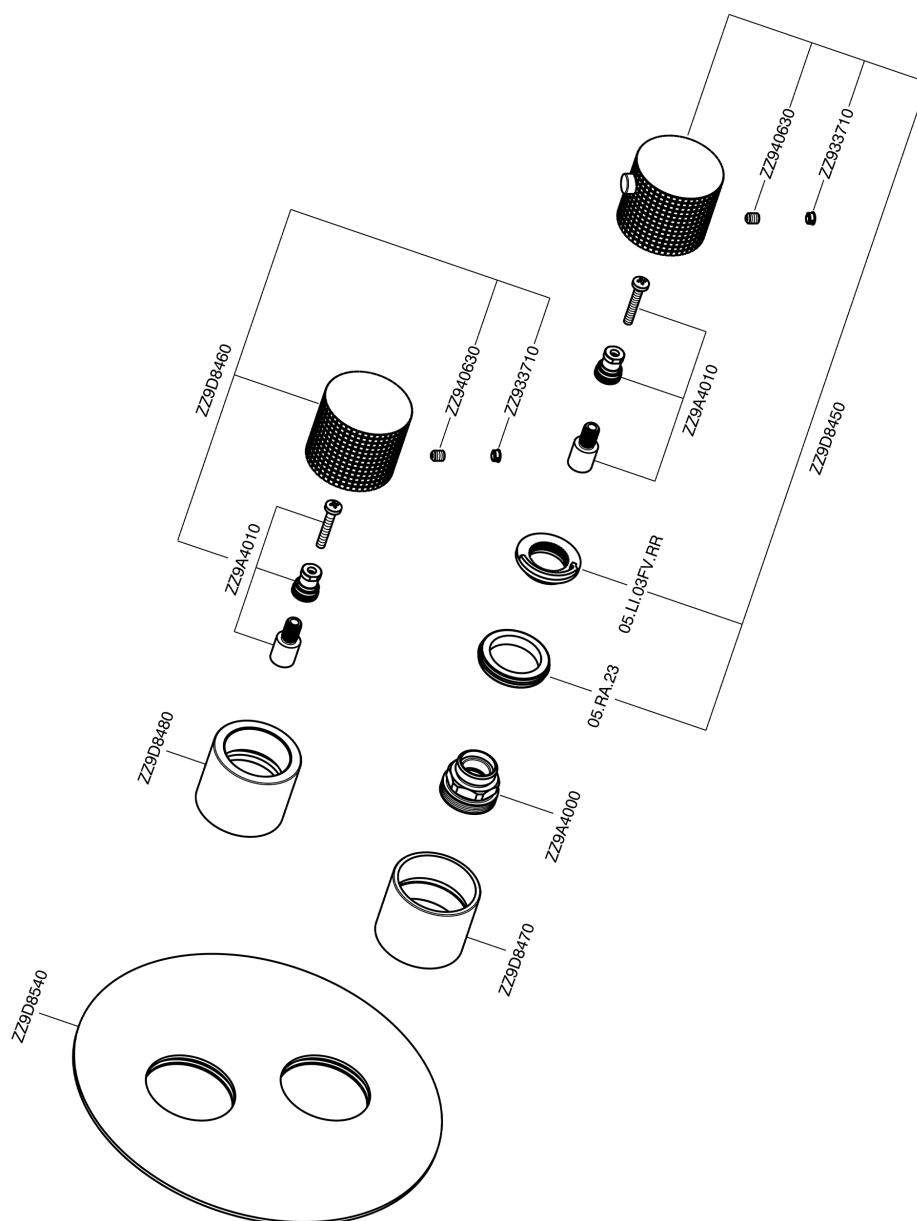

X1018100

<https://en.cisal.it/exposed-part-for-con-thermo-shower-valve-2-outlet-x32x1018100>

Concealed thermostatic shower valve, 2-outlets CONCEALED_ZA018101

MODEL **ZA018101**

Concealed thermostatic shower valve, 2-outlets, with 1/2" 2 outlet devistop cartridge, without trim kit

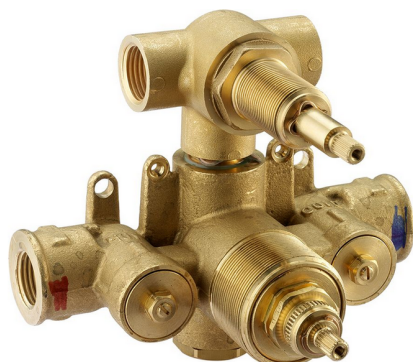

AVAILABLE FINISHINGS



04 04 Without finishing

CHARACTERISTICS

Concealed **1**
 Cartridge Spare Parts **24.04A.PP**
8x20 Plus P Thermostatic Valve

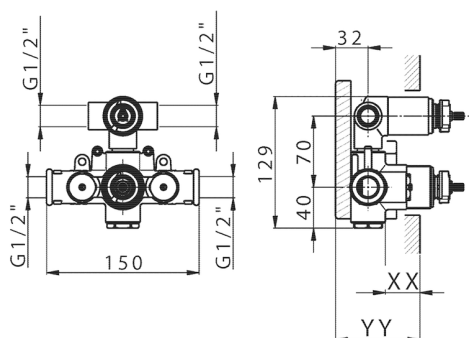

Piastra/Plate/Plaque/Platte/Placa

2-3mm: XX 25-40 YY 76-91

10 mm: XX 16-31 YY 65-80



DeviaStop

The Cisal Devia Stop technology allows to adjust the water flow and to direct it to the selected output point (overhead soaker, hand shower, etc).



Thermostatic

The Cisal thermostatic is your personal water manager, helping you to handle, control and save water and energy.



2024-05-17