

## Exposed sink mixer ARCANA CERAMIC\_AC000400

MODEL **AC000400**

Exposed sink mixer, swivel spout



### AVAILABLE FINISHINGS

- 
**21** 21 Chrome
- 
**24** 24 Gold
- 
**26** 26 Old Copper
- 
**27** 27 Old Bronze
- 
**2A** 2A Satin Brushed Nickel
- 
**74** 74 Chrome/Gold

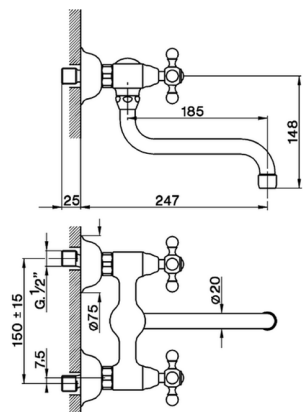

### CHARACTERISTICS



## Exposed sink mixer ARCANA CERAMIC\_AC000400

**cisal**

**AC 00040** (AC 00044)

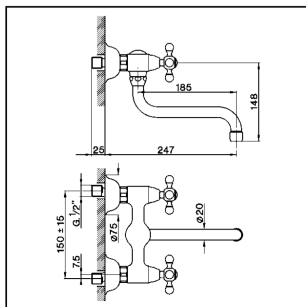

- Gruppo lavello
- *Sink mixer*
- Spültisch-Wandbatterie
- *Mélangeur évier mural*

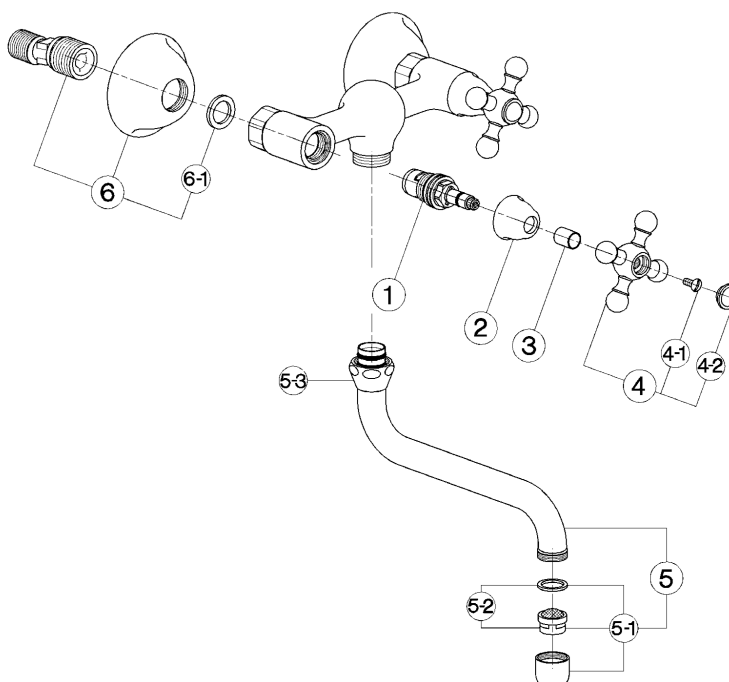

bar	PORTATA * FLOW RATE DURCHFLOß DEBIT l/min.
0.5	10
1	14
2	19.5
3	24
4	27.5
5	31

\* con resistenza silenziosa della classe di portata B (25,2 l/min. a 3 bar)  
with hydraulic resistance of flow rate class B (25.2 l/min. at 3 bar)  
mit geräuscharmen Widerstand der Durchflussklasse B (25,2 l/min. bei 3 bar)  
avec aéreur classe B (25,2 l/min. à 3 bar)

NR.	DESCRIZIONE DESCRIPTION BESCHREIBUNG DESCRIPTION	N. CODICE CODE NO. WERKS.NR. NR. CODE	NR.	DESCRIZIONE DESCRIPTION BESCHREIBUNG DESCRIPTION	N. CODICE CODE NO. WERKS.NR. NR. CODE	NR.	DESCRIZIONE DESCRIPTION BESCHREIBUNG DESCRIPTION	N. CODICE CODE NO. WERKS.NR. NR. CODE
1	Vitone ceramico DX per motori e gruppi "AC" <i>Ceramic headvalve 1/2" right "AC"-short</i> Keramikkoberteil 1/2"-rechts-"AC"-kurz <i>Tête céramique 1/2" droite "AC"- courte</i>	ZZ 92858 0	5	Canna a S Ø20 interasse 185 <i>Swinging spout 185 Ø20</i> Auslauf-Rohr-S-185 Ø20 <i>Bec orientable 185 Ø20</i>	ZZ 90118 0			
2	Cappuccio coprivitone Ø32 H.21 "AC" <i>Escutcheon Ø32 H.21 "AC" headvalve</i> Abdeckkappe Ø32 H.21 "AC" <i>Rosace couvre-tête Ø32 H.21 "AC"</i>	ZZ92652 0	5-1	Aeratore M.22x1 IB <i>Mousseur M.22x1 IB</i> Perlator M.22x1 IB <i>Mousseur M.22x1 IB</i>	ZZ 92841 0			
3	Tubetto copriasta "AR" H.15,5 <i>Sliding cover tube "AR" H.15,5</i> Abdeckkappe Oberteil "AR" H.15,5 <i>Tube couvre-tête "AR" H.15,5</i>	ZZ 92619 0	5-2	Cartuccia per aeratore M. 22x1 <i>Mousseur cartridge M.22x1</i> Kart. 1/Perlator M.22x1 <i>Cartouche x mousseur M.22x1</i>	ZZ 92703 0			
4	Maniglia "AR" con vite e placchetta <i>Handle with screw and plate "AR"</i> Griff "AR" mit Schraube und Abdeckkappe <i>Croisillon avec vis et plaque "AR"</i>	ZZ 90307 0	5-3	Calotta 3/4" es.29 Ø19,5 <i>Nut 3/4" Ø19,5</i> Mutter 3/4" Ø19,5 <i>Ecrou 3/4" Ø19,5</i>	ZZ 92615 0			
4-1	Vite M.4,5x10 tb. tc. zigrinata <i>Screw M.4,5x10</i> Schraube M.4,5x10 <i>Vis M.4,5x10</i>	ZZ 92609 0	6	Eccentrico con rosone "AC" <i>Eccentric connection with escutcheon "AC"</i> S - Anschluss m.Rosette "AC" <i>Eccentrique + rosace "AC"</i>	ZZ 92826 0			
4-2	Placchetta a vite maniglia "AR" <i>Cap for handle "AR"</i> Abdeckkappe "AR" Griff <i>Plaquette cache - vis crois "AR"</i>	ZZ 92617 0	6-1	Guarnizione NBR 90 SH. 24x16x2,7 <i>Gasket NBR 90 SH. 24x16x2,7</i> Dichtung NBR 90 SH. 24x16x2,7 <i>Joint NBR 90 SH. 24x16x2,7</i>	ZZ 92689 0			

AC.5

AC000400

<https://en.cisal.it/exposed-sink-mixer-arcana-ceramicac000400>

2024-05-05