

Exposed sink mixer ARCANA CERAMIC_AC000400

cisal

AC 00040 (AC 00044)

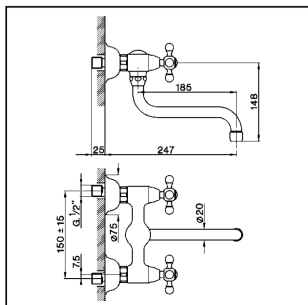

- Gruppo lavello
- Sink mixer
- Spültisch-Wandbatterie
- Mélangeur évier mural

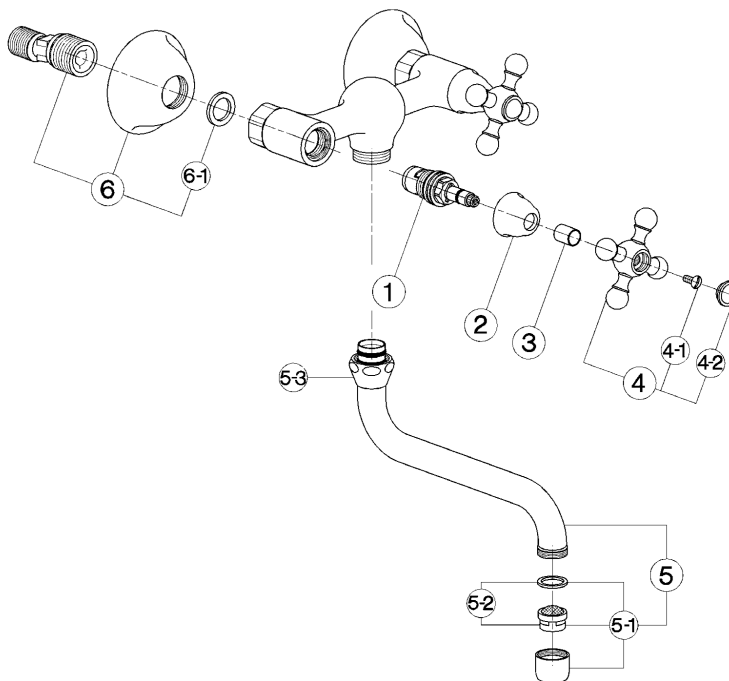

| bar | PORTATA * FLOW RATE DURCHFLOSS DEBIT l/min. |
|-----|---|
| 0.5 | 10 |
| 1 | 14 |
| 2 | 19.5 |
| 3 | 24 |
| 4 | 27.5 |
| 5 | 31 |

* con resistenza silenziosa della classe di portata B (25.2 l/min. a 3 bar)
with hydraulic resistance of flow rate class B (25.2 l/min. at 3 bar)
mit geräuscharmen Widerstand der Durchflussklasse B (25.2 l/min. bei 3 bar)
avec aérateur classe B (25.2 l/min. à 3 bar)

| NR. | DESCRIZIONE DESCRIPTION BESCHREIBUNG DESCRIPTION | N. CODICE CODE NO. WERKSNR. NR. CODE | NR. | DESCRIZIONE DESCRIPTION BESCHREIBUNG DESCRIPTION | N. CODICE CODE NO. WERKSNR. NR. CODE | NR. | DESCRIZIONE DESCRIPTION BESCHREIBUNG DESCRIPTION | N. CODICE CODE NO. WERKSNR. NR. CODE |
|-----|---|---|-----|---|---|-----|---|---|
| 1 | Vitone ceramico DX per monotori e gruppi "AC" Ceramic headvalve 1/2" right "AC"-short Keramikoberteil 1/2"-rechts-"AC"-kurz Tête céramique 1/2" droite "AC" - courte | ZZ 92858 0 | 5 | Canna a S Ø20 interasse 185 Swirling spout 185 Ø20 Auslauf-Rohr-S-185 Ø20 Bec orientable 185 Ø20 | ZZ 90118 0 | | | |
| 2 | Cappuccio coprivite Ø32 H.21 "AC" Escutcheon Ø32 H.21 "AC" headvalve Abdeckkappe Ø32 H.21 "AC" Rosace couvre-tête Ø32 H.21 "AC" | ZZ92652 0 | 5-1 | Aeratore M.22x1 1B Mousseur M.22x1 1B Perforator M.22x1 1B Mousseur M.22x1 1B | ZZ 92841 0 | | | |
| 3 | Tubetto copriasta "AR" H.15,5 Sliding cover tube "AR" H.15,5 Abdeckkappe Oberteil "AR" H.15,5 Tube couvre-tête "AR" H.15,5 | ZZ 92619 0 | 5-2 | Cartuccia per aeratore M. 22x1 Mousseur cartridge M.22x1 Kart. 1/Perforator M.22x1 Cartouche v mousseur M.22x1 | ZZ 92703 0 | | | |
| 4 | Maniglia "AR" con vite e placchetta Handle with screw and plate "AR" Griff "AR" mit Schraube und Abdeckkappe Croisillon avec vis et plaquette "AR" | ZZ 90307 0 | 5-3 | Calotta 3/4" es.29 Ø19,5 Nut 3/4" Ø19,5 Mutter 3/4" Ø19,5 Ecrou 3/4" Ø19,5 | ZZ 92615 0 | | | |
| 4-1 | Vite M.4,5x10 lb. tc. zigrinata Screw M.4,5x10 Schraube M.4,5x10 Vis M.4,5x10 | ZZ 92609 0 | 6 | Eccentrico con rosone "AC" Excentric connection with escutcheon "AC" S - Anschluss m. Rosette "AC" Excentrique + rosace "AC" | ZZ 92826 0 | | | |
| 4-2 | Placchetta a vite maniglia "AR" Cap for handle "AR" Abdeckkappe "AR" Griff Plaquette cache - vis crois. "AR" | ZZ 92617 0 | 6-1 | Guarnizione NBR 90 SH. 24x16x2,7 Gasket NBR 90 SH. 24x16x2,7 S - Anschluss m. Rosette "AC" Excentrique + rosace "AC" | ZZ 92689 0 | | | |

AC.5

AC000400

<https://en.cisal.it/exposed-sink-mixer-arcana-ceramic-ac000400>

2024-12-26