

## Stopvalve exposed part SLIM\_SM003310

MODEL **SM003310**

Stopvalve exposed part, without concealed part, for item ZA003330



### AVAILABLE FINISHINGS



**21** 21 Chrome



**2B** 2B Polished Nickel



**40** 40 Matt Black



**4Q** 4Q Matt White

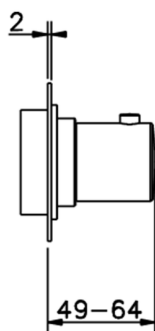
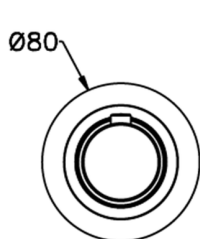

### CHARACTERISTICS

Installation **Concealed**

Required concealed parts **ZA003330**



## 3/4 Stopvalve concealed part CONCEALED\_ZA003330

MODEL **ZA003330**

3/4" Stopvalve concealed part, opening counterclockwise



AVAILABLE FINISHINGS



**04** 04 Without finishing

CHARACTERISTICS

Concealed **1**

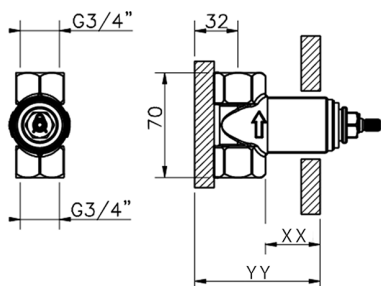

Piastra/Plate/Plaque/Platte/Placa

2-3mm: XX 31-46 YY 80-95

10mm: XX 25-40 YY 76-91



2024-04-29